



**Brush Cutter
For
Skid Steer Loaders**

XBC60 & XBC72



Unit Specifications:

DATE PURCHASED _____ DATE MFG. _____

MOTOR TYPE _____

DO NOT EXCEED _____ GALLONS PER MINUTE!!

TABLE OF CONTENTS

TOPIC	PAGE
Letter from Owner -----	3
Warranty Information-----	4
IMPORTANT SAFETY PRECAUTIONS	
General Warnings -----	5
Debris Discharge Warnings -----	5
Rotating Parts Warnings -----	6
Hydraulic System Warnings -----	6
OPERATING INSTRUCTIONS	
Attachment of Machine-----	7
Cutting Operation -----	7

"THE UNIVERSAL BRUSH CUTTER FOR SKID STEER LOADERS"

Dear Customer,

Thank you and congratulations on the purchase of your new Brush Cutter! We strive to manufacture the best hydraulic brush cutter for skid steer loaders on the market today. No matter which unit that you purchased, you can rest assured that it was manufactured to rigid quality standards, utilizing the highest technology in hydraulic system components that are available. All of our units feature breakaway blades, the ability to cut bi-directional and built-in cushion valves for smooth shut-down and reduced wear on the hydraulic motor. Our cutters were designed and manufactured to cut nearly all types of brush, shrubs, and small trees over a wide variety of terrains. When attached to your skid steer loader, it is highly maneuverable for close cutting in tight areas.

Please take the time to thoroughly read this informative owner's manual. Be sure to pay particularly close attention to the safety portion of this manual. Remember, the safety guidelines that are mentioned in this manual are not only for your safety, but also for the safety of others. Only with a complete understanding of your cutter will you be able to operate it to its full potential.

Thanks again for your purchase. As always, if you have any questions about your Brush Cutter, or would like to give us feedback, feel free to contact us. We will be happy to help you in any way that we can.

Sincerely,

Tar River Implements

WARRANTY INFORMATION

LIMITED WARRANTY

We warrant each new brush cutter unit to be free from defects in materials and workmanship for a period of one year from the date of purchase if the unit has been properly maintained and lubricated as directed according to the operation and maintenance instructions listed in this manual. We will replace, free of charge, any component that is defective due to quality of material or workmanship for the ONE-YEAR period.

NON-COVERED ITEMS

The above limited warranty does not include nor cover blades, blade bolts or hoses. Wear of these items is a direct result from normal and recommended use.

EXCLUSIONS TO THE LIMITED WARRANTY

Repairs to any component of this machine performed by any firm or individual other than the original manufacturer will void all warranties. Replacement parts not supplied by the original manufacturer will void all warranties. Damage due to repairs, accidents, or operator abuse and neglect, and failure to maintain this machine according to the maintenance and operation instruction listed in this manual, will void all warranties. Disassembly of the motor will void motor warranty. Use of a standard flow Brush Cutter on a "high flow" skid steer loader will cause damage to the cutter's hydraulic motor. Such use shall void all warranties.

WARRANTY STATEMENT

Our obligation under this Limited Warranty shall be solely limited to repairing or replacing any part (excluding blades, blade bolts and hoses) free of charge that, according to our judgment, shows evidence of a defect in quality of material or workmanship for the stated ONE-YEAR warranty period. This Limited Warranty shall not be interpreted to render the manufacturer liable for any injury or damage to persons, business, or property of any kind nor expenses or losses incurred for labor, supplies, substitute machinery rental, or for any other reason. Repaired or replaced parts are subject to the supply conditions at the time of repair or replacement, which may directly affect our ability to obtain materials and/or replacement parts. We reserve the right to make improvements in design or changes in specifications at any time, without incurring any obligations to owners of previously purchased units.

IMPORTANT SAFETY PRECAUTIONS

Look for the  symbol throughout this manual to point out important safety precautions. Remember, the safety of both yourself and others is involved in the operation of this equipment.

GENERAL WARNINGS

- NEVER operate this or any other equipment under the influence of drugs or alcohol.
- NEVER carry passengers on the Brush Cutter.
- NEVER leave the Brush Cutter unattended in a raised position.
- ALWAYS stop and inspect both the skid steer loader and cutter for damage after striking a foreign object. Any damage should be repaired prior to restarting the skid steer loader engine and resuming cutting.
- Cut only in daylight or well-lit artificial light.
- Keep all nuts, bolts, and screws tight and be sure the equipment is in safe operating condition and check the blade mounting bolts for proper tightness at frequent intervals.
- If attached to your skid steer loader, visually inspect your lock-on pins to ensure that the Brush Cutter is locked onto your skid steer loader. Remember, the Brush Cutter is made of all steel components and is extremely heavy.
- When working under the deck of the Brush Cutter, always securely block it up to reduce the risk of it falling.
- Reduce speeds on slopes and make turns gradually to prevent tipping or loss of control. Exercise extreme caution while making turns on slopes.
- Stay alert for holes or drop-offs on all terrains.
- Use caution when walking on the deck of the Brush Cutter. The deck may be extremely slick when wet.
- NEVER operate your Brush Cutter with the deck raised more than two (2) feet.
- ALWAYS operate with safety chain attached.
- KEEP CHILDREN AWAY FROM THE CUTTING AREA AT ALL TIMES.

DEBRIS DISCHARGE WARNINGS

Your brush cutter discharges debris out the front of the machine. When cutting with the Brush Cutter, NEVER discharge material toward bystanders. All bystanders must be AT LEAST 75 feet away when operating the cutter. NEVER allow bystanders near the machine while it is in operation. When cutting near bystanders is unavoidable, DO NOT operate the cutter without the front guard flap in place (if equipped with guard flap).

- ALWAYS clear the cutting area of objects (bottles, rocks, fencing, wire, etc.) that may be picked up and thrown.
 - ALWAYS use a shatterproof cab door or the 3/8" thick safety chain that came with your Brush Cutter (optional) when cutting. The door is used not only to protect the operator from flying debris, but also from overhanging or protruding objects (tree limbs, rebar, vines, etc.) from entering the cab and causing operator injury.
-

IMPORTANT SAFETY PRECAUTIONS



ROTATING PARTS WARNINGS

- ALWAYS disengage power to the Brush Cutter and shut the skid steer loader engine off prior to leaving the operator's cab or performing any inspection or maintenance to either the brush cutter or the skid steer loader.
- NEVER place hands or feet under the Brush Cutter deck or near the blade system while the unit is **in** operation.
- NEVER articulate (roll) the deck downward to a degree that exposes the operator to the blade system.



HYDRAULIC SYSTEM WARNINGS

- ALWAYS release the pressure on the hydraulic system of the cutter prior to removing the attachment from the skid steer loader or working on any part of the hydraulic system. Hydraulic hoses and components operate under extreme pressure and heat. A small stream of fluid from a pinhole leak **in** a hydraulic hose can penetrate the skin and/or cause burns. Whenever hydraulic fluid is injected into the body, seek medical attention at once to reduce chances of a dangerous infection. ALWAYS wash skin with soap and water after contact with hydraulic fluid, as it is an irritant to skin and eyes.
 - Your Brush Cutter has been designed to reduce the likelihood of hydraulic system leakage. Each and every hydraulic system is checked prior to shipment. However, over time, any hydraulic system may develop fluid leaks. Small leaks may produce high-pressure discharge flows capable of causing injury should skin come in contact with such discharge.
 - Leaking fluid can make the deck and ground surfaces very slippery, causing difficulty in using tools and also increasing the possibility of slips and falls. ALWAYS wipe away all fluid that may have leaked during maintenance.
 - NEVER operate a Brush Cutter on a "high-flow" skid steer loader unless the cutter is equipped with a "high-flow" motor. Motor failure can occur if such use is performed. Damage incurred to the hydraulic motor due to "high - flow" usage is not covered. Please refer to the front cover of the manual for the maximum allowable flow for your Brush Cutter.
-

OPERATING INSTRUCTIONS



OPERATING WARNING

Before operating and after 8 hours of use, check torque on all bolts and nuts.

ATTACHMENT OF MACHINE

The installation of your Brush Cutter is the same for any other powered attachment for your skid steer loader:

1. Using the attached instructions, connect the Safety chain to skid steer prior to using Brush Cutter. (Page 8)
2. Pull up to the brush cutter and connect it to your skid steer loader.
3. Secure the lock down lever or levers.
4. Connect the hydraulic hoses from the brush cutter to your machine. The hoses provided are equipped with quick-disconnect fittings (both male and female) for ease of use.

CUTTING OPERATION

The brush cutter is capable of, and in fact intended to be utilized for, mulching trees and other vegetation of varying heights and diameters of up to 5"-6". As a safety feature, when cutting large diameter vegetation, the Brush Cutter is equipped with a hydraulic motor cushion valve for shut down of the blade system. This feature lessens the chance of damaging the cutter's hydraulic system or blade system when cutting larger diameter vegetation. Directions for use are as follows:

CUTTING GROUND LEVEL VEGETATION

Raise the rear of the brush cutter approximately 4"-5" above ground level. The deck of the brush cutter should be sloping downward and away from the operator. This is the optimum position for cutting materials that are close to the ground. Please note: If the operator can see the blade system in operation, the back of the brush cutter is raised TOO HIGH !

CUTTING ABOVE GROUND LEVEL VEGETATION

Raise the front deck of the brush cutter up approximately 1' 2' above ground level. Do not lift the rear portion of the deck. Keep it approximately 4" -5" above ground level. Slowly drive into the vegetation and use the hydraulic tilt (roll) to bend or push the vegetation over. As you bend the vegetation over and drive into it, the blades will cut it into. The vegetation can now be mulched by rotating the front of the brush cutter and driving forward several feet. Then roll the back of the cutter down and back-drag atop the vegetation.



Step 1: Find link hole at back of unit

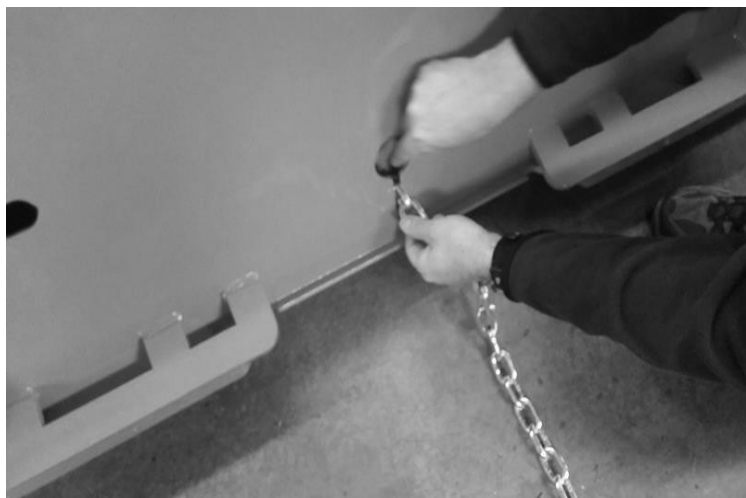

Step 2: Using one end of safety chain, drop number of desired links into link hole. Once chain is in place check to ensure it is secure and cannot be pulled back through link hole.

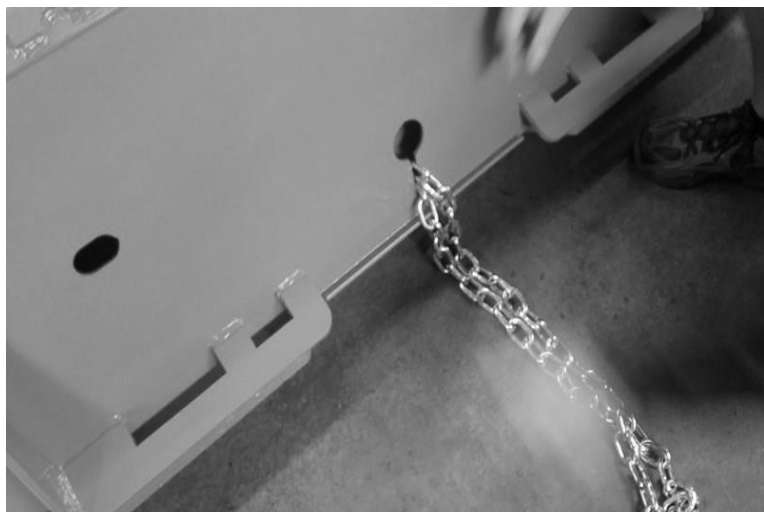

Step 3: Take the loose end of the chain and secure it to the Brush Cutter.

Step 4: Pull chain back to Brush Cutter placing this end of the chain into the link hole. Make sure this end of the chain is secure and cannot be pulled back through the link hole. After following these steps to ensure the safety chain is properly connected. You may now proceed to connect skid steer to the Brush Cutter.

Brush Cutter

The TRA S.rush Cultter is one of the most durable and powerful cutters on the market, engineered to take on the challenge of land clearing.

- Durable powder coat finish
- flat face fittings factory installed and included
- Bidirectional blades
- Built in relief valve
- Heavy duty bearing assembly
- Durable Drive Unit
- 6" Cutting Capacity
- front push bar
- Oil Level Sight Glass



Motor (GPM)	Low/Mid/High 16/30
Drive Unit (HP)	150
Deck (inches)	3/16 or 1/4 A-36 Steel
Blade	AIR-500
Blade Carrier (inches)	1/2 A-36 Steel

Higher Flow Rates Available, Please call for more info.

Model 60" 2 Blade 72" 2 Blade 60" 3 Blade 72" 3 Blade
Standard 3/16 Deck

Product Number	10421R060	10421R072	104TR060	104TR072
Blades	2	2	3	3
Deck Thickness (inches)	3/16	3/16	3/16	3/16
Weight (lbs.)	1242	1297	1289	1377

Model Upgrade 60" 2 Blade **72" 2 Blade** 60" 3 Blade 72" 3 Blade
Heavy Duty 1/4 Deck

Product Number	10421R060QTR	10421R072QTR	104TR060QTR	104TR072QTR
Blades	2	2	3	3
Deck Thickness (inches)	1/4	1/4	1/4	1/4
Weight (lbs.)	1322	1377	1369	1457

{Subject to change without notice}

Tar River Attachments
401 Jeffreys Road
Rocky Mount, NC 27804

4,000 Series
Eaton Motor

Cross flow Rcelief

Motor Ring
Seat

(4) ½" Allen Head
Cap Screws

(8) 5/8-18
locknuts &
Washers

594A Bottom
Bearing (NAPA),
PT#: BRG SET 403

Spjndle

Pro Torque Lock Nut
(NAPA) PT# 449-4973
TWD4494973

580 Top Bearing

(NAPA) PT# BRG SET
401

(10) ¾-10X 2 ½
Bolts

(10) ¾-10 Locknuts

Hub Assembly
with Seal (NAPA)
PT#
TWD264310T

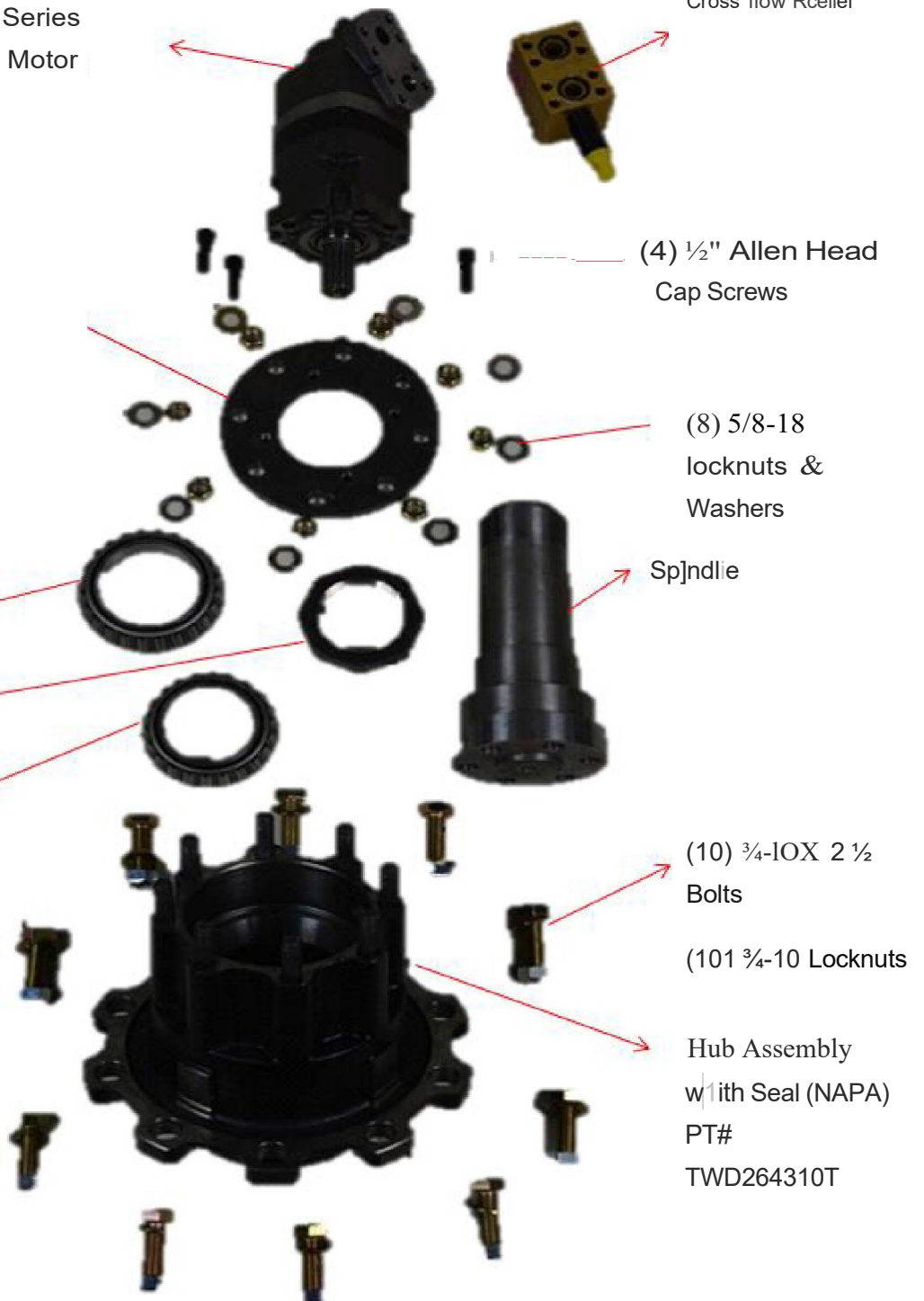

(1.) Hydraulic Motor -----

Motor Bolts 4 -----
(1.) 1/2 x 1 3/4" Allen Head

(5.) Motor Gasket -----

(7.) Motor Plate Gasket -----

(9.) Lock Nut -----

(10.) Bearing -----

(11.) Sight Glass -----

(12.) Stover Lock Nut $GR. < 10 \times 11$
5/8" ID. 15/16" OD

(15.) Hub -----

(18.) Oil Seal -----

(19.) Spindle -----

(20.) Flat Washers - 6
SAE: 3/4" GRADE 8

(21.) Bolts - 6 Pilot Thread GRADE 8
3/4" x 1 1/2" Hex Head

(3.) Lock Washers - 4
1/2" High Carrier

(4.) Motor Plate Bolts - 4 GRADE 8
5/8" x 1 1/2" Allen Head

(6.) Motor Plate

(8.) Retainer Clip

(12.) Breather

(14.) Washer GRADE 8
SAE 5/8"

(16.) Bolts - 4 GRADE 8
5/8" x 2 1/2" Hex Head

(17.) Bearing

(22.) Blade Carrier attaches here

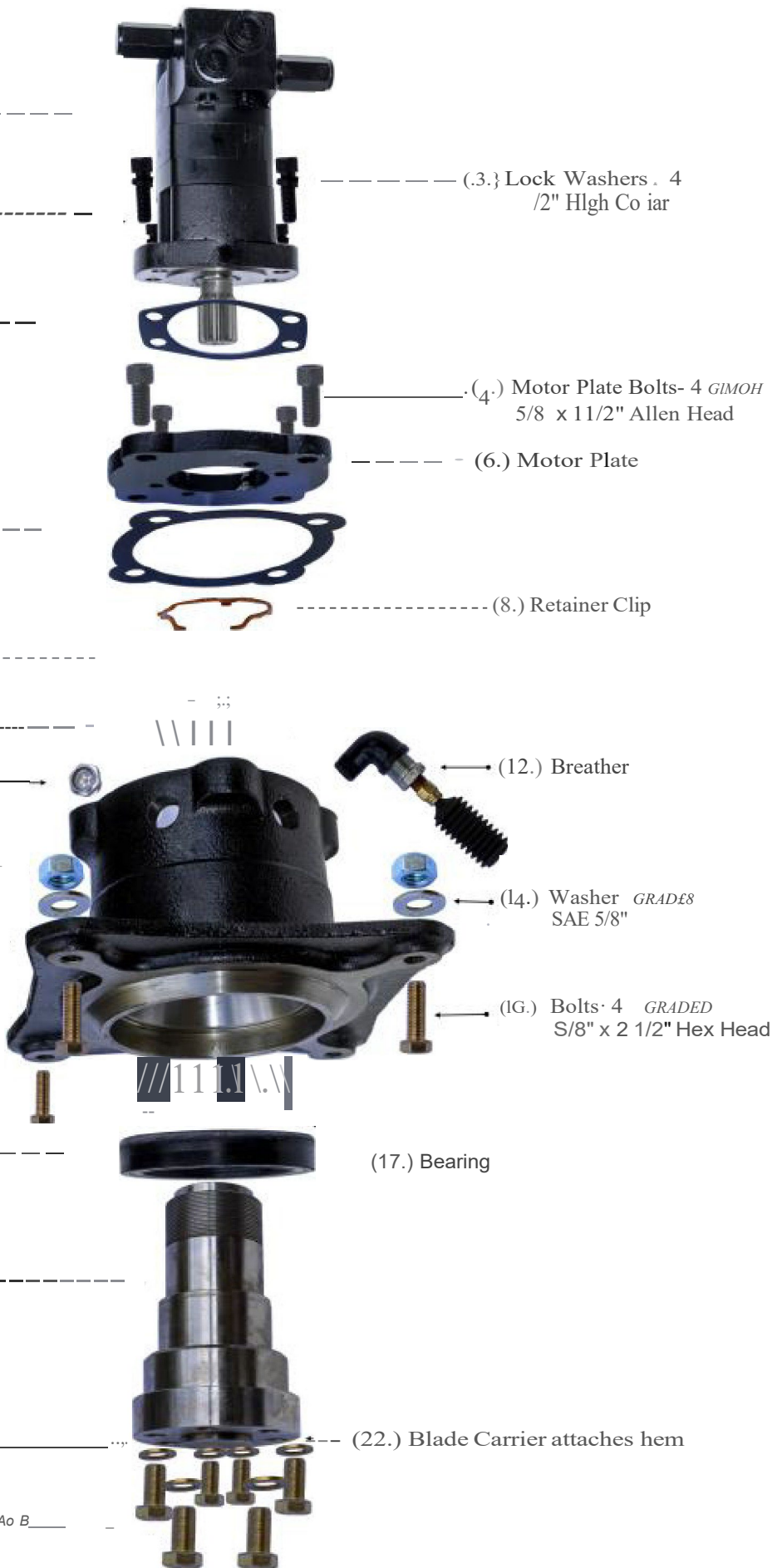



PN	Description
XBC0001	Blade kit w/hardware (Kit includes; 1 blade, 1 bolt PN XBC0013, 1 lock nut PN XBC0014) (Old style with 2 blades).
XBC0002	Blade kit w/puck and hardware (Kit includes; 1 blade, 1 bolt PN XBC0013 and 1 lock nut PN XBC0014) (New style with 3 blades).
XBC0017	Blade - XBC
XBC0018	Puck

ADDITIONAL SAFETY MESSAGES



WARNING Cancer and Reproductive Harm www.P65Warnings.ca.gov

FEDERAL LAWS AND REGULATIONS

This section is intended to explain in broad terms the concept and effect of federal laws and regulations concerning employer and employee equipment operators. This section is not intended as a legal interpretation of the law and should not be considered as such.

Employer-Employee Operator Regulations

U.S. Public Law 91-596 (The Williams-Steiger Occupational and Health Act of 1970) OSHA

This Act Seeks:

"...to assure so far as possible every working man and woman in the nation safe and healthful working conditions and to preserve our human resources..."

DUTIES

Sec. 5 (a) Each employer-

- (1) shall furnish to each of his employees employment and a place of employment which are free from recognized hazards that are causing or are likely to cause death or serious physical harm to his employees;
- (2) shall comply with occupational safety and health standards promulgated under this Act.
- (b) Each employee shall comply with occupational safety and health standards and all rules, regulations and orders issued pursuant to this Act which are applicable to his own actions and conduct.

OSHA Training Requirements

Title 29, Code of Federal Regulations Part 1928.57(a)(6). www.osha.gov

Operator instructions. At the time of initial assignment and at least annually thereafter, the employer shall instruct every employee who operates an agricultural tractor and implements in the safe operating practices and servicing of equipment with which they are or will be involved, and of any other practices dictated by the work environment.

Keep all guards in place when the machine is in operation;

Permit no riders on equipment

Stop engine, disconnect the power source, and wait for all machine movement to stop before servicing, adjusting, cleaning or unclogging the equipment, except where the machine must be running to be properly serviced or maintained, in which case the employer shall instruct employees as to all steps and procedures which are necessary to safely service or maintain the equipment.

Make sure everyone is clear of machinery before starting the engine, engaging power, or operating the machine.

Employer Responsibilities:

To ensure employee safety during Tractor and Implement operation, it is the employer's responsibility to:

1. Train the employee in the proper and safe operation of the Tractor and Implement.
2. Require that the employee read and fully understand the Tractor and Implement Operator's manual.
3. Permit only qualified and properly trained employees to operate the Tractor and Implement.
4. Maintain the Tractor and Implement in a safe operational condition and maintain all shields and guards on the equipment.
5. Ensure the Tractor is equipped with a functional ROPS and seat belt and require that the employee operator securely fasten the safety belt and operate with the ROPS in the raised position at all times.
6. Forbid the employee operator to carry additional riders on the Tractor or Implement.
7. Provide the required tools to maintain the Tractor and Implement in a good safe working condition and provide the necessary support devices to secure the equipment safely while performing repairs and service.
8. Require that the employee operator stop operation if bystanders or passersby come within 300 feet.

Child Labor Under 16 Years of Age

Some regulations specify that no one under the age of 16 may operate power machinery. It is your responsibility to know what these regulations are in your own area or situation. (Refer to U.S. Dept. of Labor, Employment Standard Administration, Wage & Home Division, Child Labor Bulletin #102.)



Increasing agricultural productivity since 1974

401 Jeffreys Road
Rocky Mount, NC 27804
www.BR-Equipment.com

Tel: 252-442-0700
Fax: 252-787-5855
Sales@BRGlimited.com