

PRZ-5500 Assembly Instructions

1



2



3



4



5



6



7



8



9

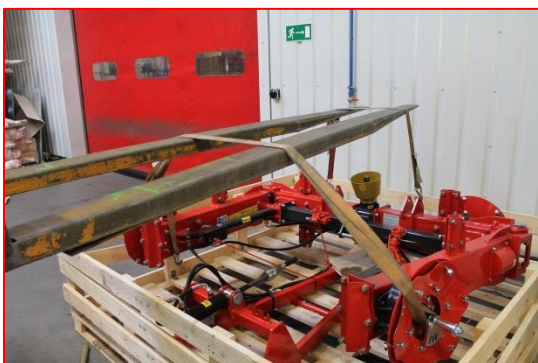

10

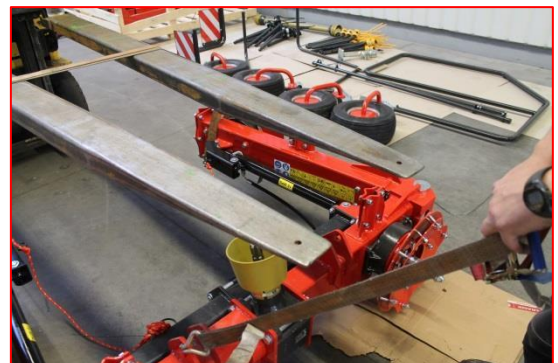

11

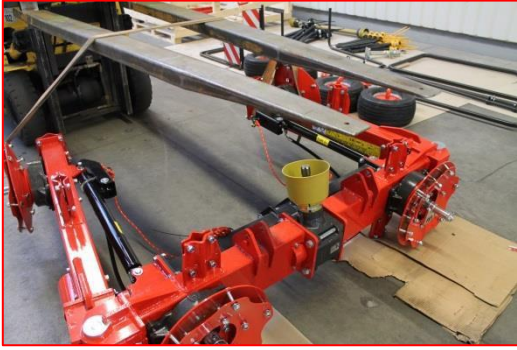

12



13

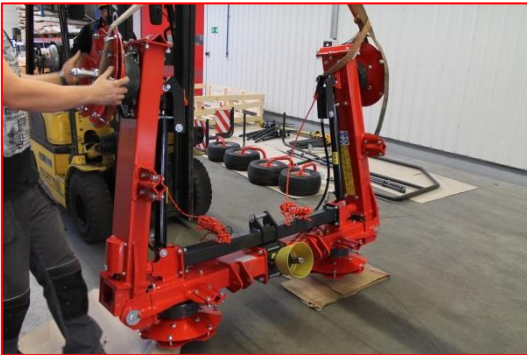

14



15



16



17

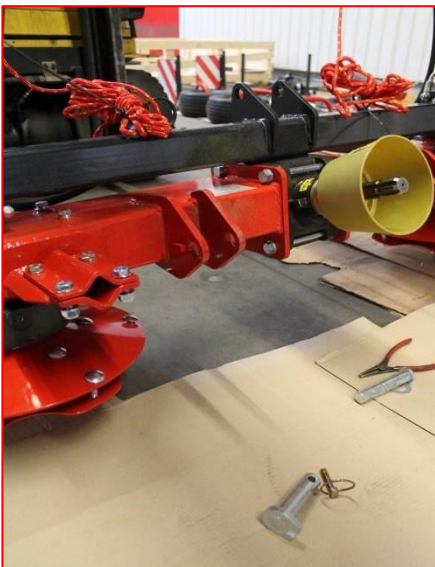

18



19



20





**Important:
Tire Assembly instructions.**

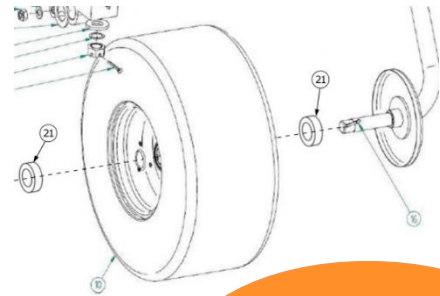

Outside tires with spindles

Hub Covers on the inside of outer and inner baskets to protect spindles

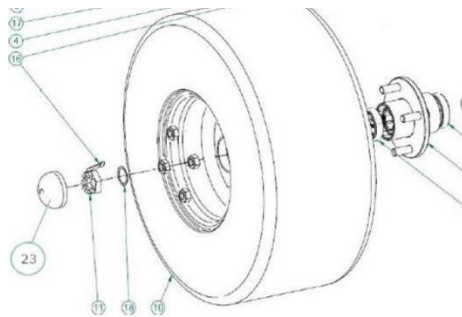

Inside tires with High-Speed Hubs

21



22

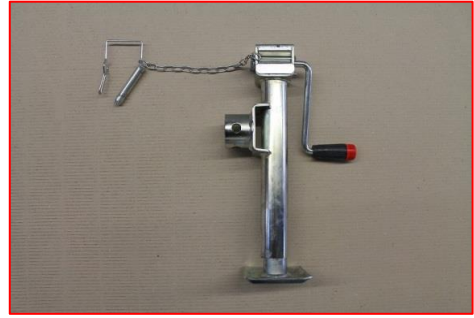

23

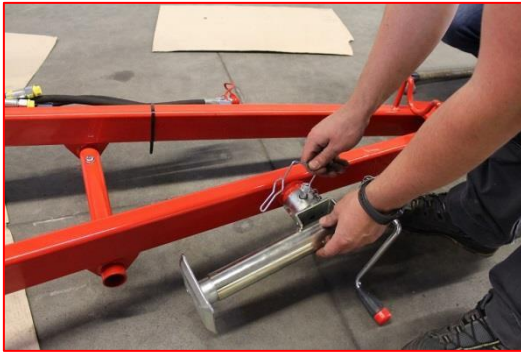

24

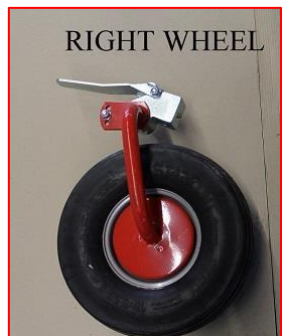

25



26



27



28



27

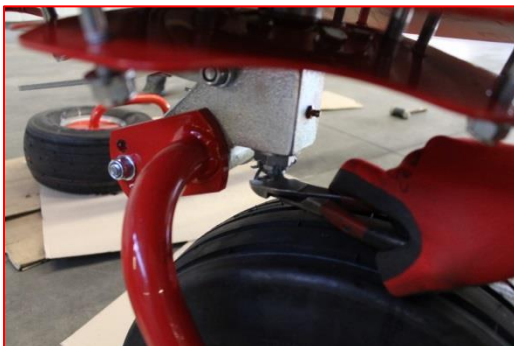

28



29



30



31



32



33

34



37

38

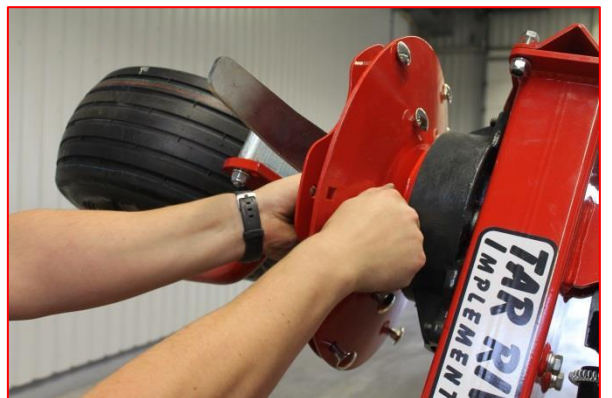

39

40

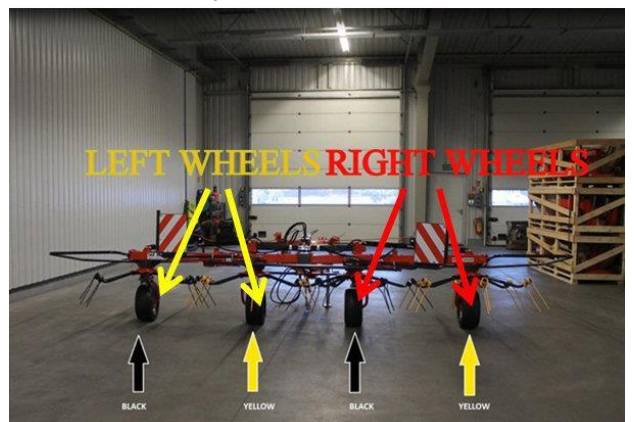
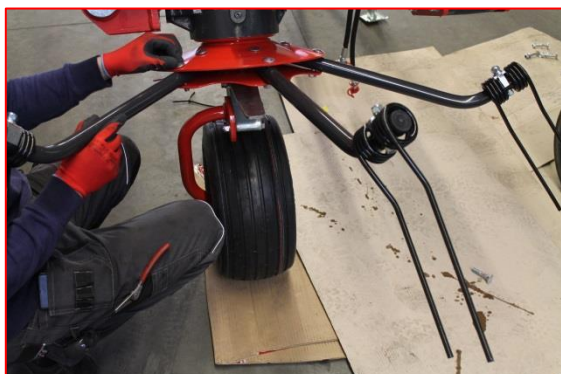

41

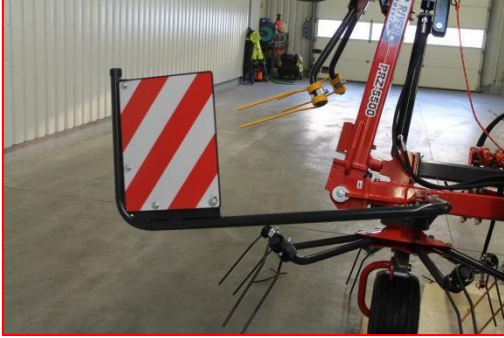

42

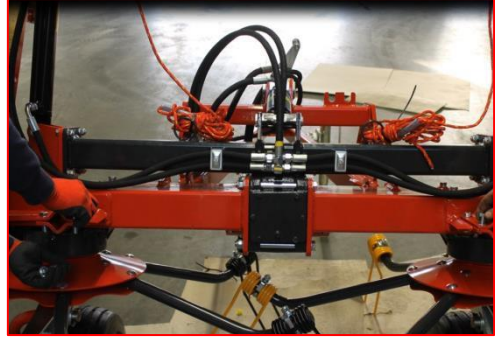

43

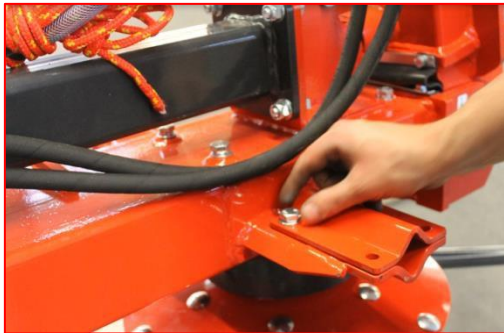

44



45



46

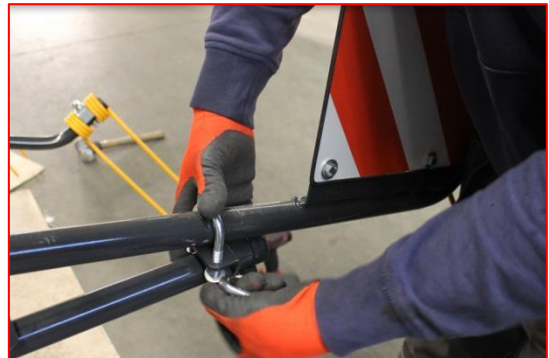

49

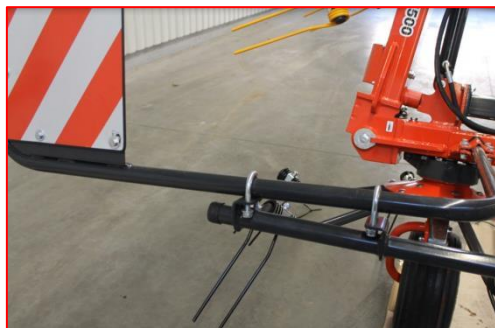

50

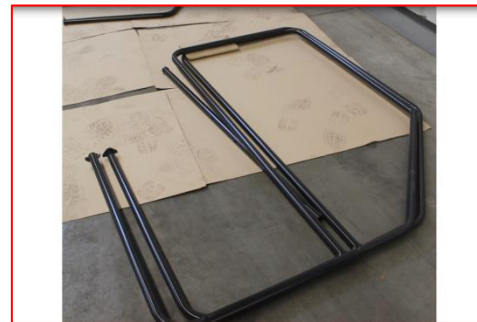

51

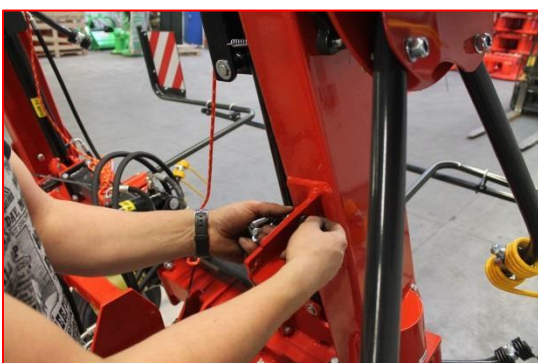

52



53



54



55

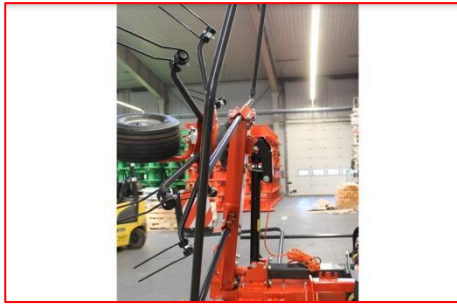

56



57



58



59



60

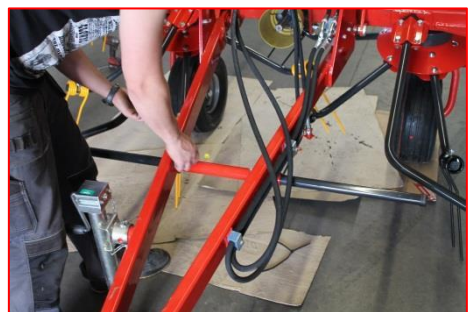

61

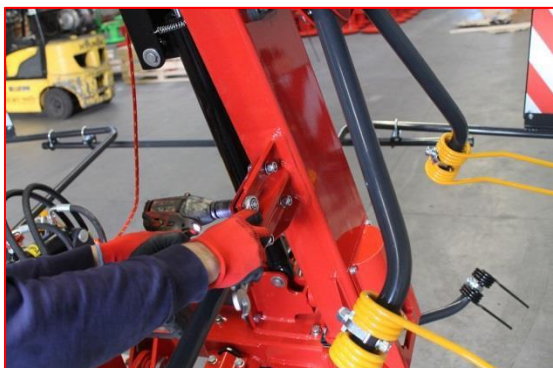

62



63



64



65



66



67



68

