

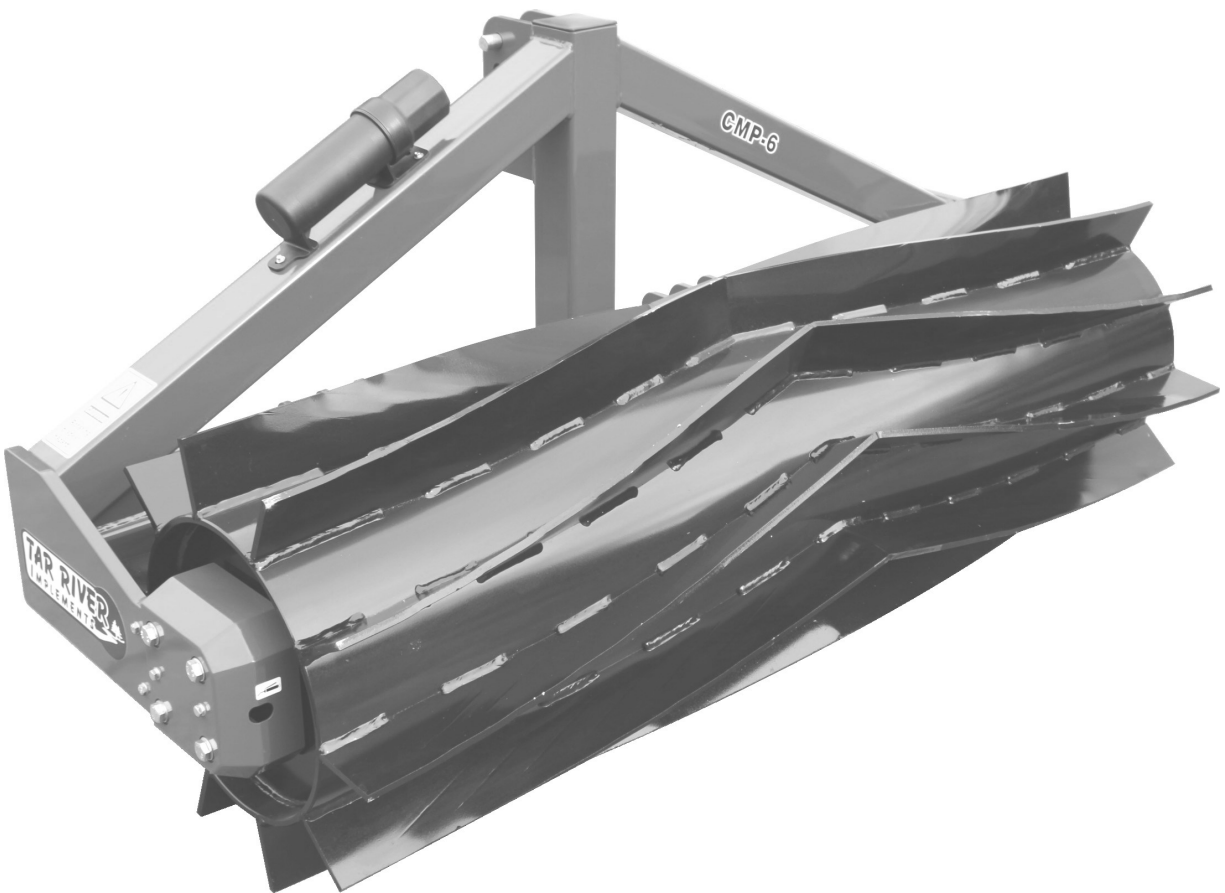

Roller Crimper

CMP-6, CMP-8, CMP-10



Operator's Manual

Rel. 02/25

Page left blank intentionally

TO THE DEALER:

Assembly and proper installation of this product is the responsibility of the Tar River dealer. Read manual instructions and safety rules. Make sure all items on the Dealer's Pre-Delivery and Delivery Check Lists in the Owner's/Operator's Manual are completed before releasing equipment to the owner.

TO THE OWNER:

Read this manual before operating your Tar River equipment. The information presented will prepare you to do a better and safer job. Keep this manual handy for ready reference. Require all operators to read this manual carefully and become acquainted with all the adjustment and operating procedures before attempting to operate. Replacement manuals can be obtained from your selling dealer. The equipment you have purchased has been carefully engineered and manufactured to provide dependable and satisfactory use. Like all mechanical products, it will require cleaning and upkeep. Lubricate the unit as specified. Observe all safety information in this manual and safety decals on the equipment. For service, your authorized Tar River dealer has trained mechanics, genuine Tar River service parts, and the necessary tools and equipment to handle all your needs. Use only genuine Tar River service parts. Substitute parts will void the warranty and may not meet standards required for safe and satisfactory operation.

Record your implement model and serial number in the space provide below. Your dealer will need this information to give you prompt, efficient service.

Model Number: _____

Serial Number: _____

Date Purchased: _____

TO THE DEALER: Part 1 of 2

Assembly and proper installation of this product is the responsibility of the Belco Resources Dealer. Read manual instructions and safety rules. Make sure all items on the Dealer's Pre-Delivery List and Owners Check List in the Owner's/Operator's Manual are completed before releasing equipment to the owner.



NOTE: The machine must be inspected thoroughly by the dealer prior to delivery of machine to owner. Place a check mark in the box beside each item checked. Contact Belco Recourses Equipment of any damages, issues or shortages to the machine.

Pre-Delivery Checklist - Dealer

- Gearbox oil level
- Check all fluids, hydraulic, gear oil, etc.
- Grease fittings properly lubricated
- Guards, shields, attachments securely fastened
- All hardware tightened
- Condition and tension of V-belts (if applicable)
- Blades properly installed, blade hardware tightened to proper torque specifications
- PTO attached to the machine (if applicable)
- All decals are clean, legible and in proper location
- Operator's Manual on machine

Model #: _____ Serial #: _____

Inspected by (Initials): _____ Date: _____

TO THE DEALER: Part 2 of 2

Dealer is to review the following items to the owner. Place a check mark in the box beside each item reviewed.

Checklist - Owner

- Correct attachment of machine to tractor
- Safe operation of the machine
- Importance of regular lubrication, maintenance and inspection
- Troubleshooting
- Replacing broken or worn parts (importance of using only OEM parts)
- Servicing the machine
- Storage
- Warranty
- Encourage owner to read and understand the Operator’s Manual before operating the machine
- Encourage owner to fill out the “Warranty Registration”, online warranty@br-equipment.com

Purchase Date: _____	Delivery Date: _____
Model #: _____	Serial #: _____
Dealer Signature _____	Date: _____
Customer Signature _____	Date: _____

TO THE OWNER:

Read this manual before operating your Belco Resources equipment. The information presented will prepare you to do a better and safer job. Keep this manual handy for ready reference. Require all operators to read this manual carefully and become acquainted with all the adjustment and operating procedures before attempting to operate. Replacement manuals can be obtained from your selling dealer. The equipment you have purchased has been carefully engineered and manufactured to provide dependable and satisfactory use. Like all mechanical products, it will require cleaning and upkeep. Lubricate the machine as specified. Observe all safety information in this manual and safety decals on the equipment. For service, your authorized Belco Resources dealer has trained mechanics, genuine Belco Resources service parts, and the necessary tools and equipment to handle all your needs. Use only genuine Belco Resources service parts. Substitute parts will void the warranty and may not meet standards required for safe and satisfactory operation.

Table of Contents

Technical Specifications	7
Safety	8
Safety Signal Words	8
General Safety Guidelines	9
Safety Decal Care	9
Before Operation	10
During Operation	11
Highway And Transport Operations	12-13
General Information.....	14-15
Operating Instructions	16-17
Maintenance & Lubrication.....	18-20
Torque Specifications	21
Parts Breakdown	23-25
Warranty	26

Technical Specifications

Thank you for purchasing your Tar River “Roller Crimper”. The Tar River Implement Roller Crimper is a tool designed to terminate cover crops by crimping the stalk rather than cutting it during its “dough stage”. This process has several benefits, including the conservation of soil moisture, reduction of erosion, lessens the need for herbicides and addition of organic matter to the soil. It also suppresses weed growth and helps to cool soil temperatures during the summer months.

It is available in an 6’, 8’ and 10’ working widths and is a useful tool for farmers and agricultural professionals who want to manage their soil health.

Technical Specifications

Model:	Working width	Overall Width	Min. HP	Cat. Hitch	Weight (lbs.)	Max. water weight w/water
CMP-6	72”	77”	30	Cat 1-2	1,127 lbs.	1,564 lbs.
CMP-8	96”	100”	40	Cat 1-2	1,404 lbs.	1,987 lbs.
CMP-10	120”	123”	50	Cat 1-2	1,724 lbs.	2,425 lbs.

Important Safety Information

Safety

It is important that you read the entire manual and to become familiar with this product before you begin using it. This product is designed for certain applications only. The manufacturer cannot be responsible for issues arising from modification. We strongly recommend this product not be modified and /or used for any application other than that for which it is designed. If you have any questions relative to a particular application, DO NOT use the product until you have first contacted us to determine if it can or should be performed on the product.

Read and understand this manual and all safety signs before operating and maintaining . Review the safety instructions and precautions annually.

Safety Signal Words

TAKE NOTE! This safety alert symbol found though out this manual is used to call you attention to instructions involving you personal safety and the safety of others. Failure to follow these instructions can result in injury or death.



**This symbol means:
Attention!
Become alert!
Your safety is involved!**

Note the use of the signal words, **DANGER**, **WARNING** and **CAUTION** with the safety messages. The appropriate signal word for each has been selected using the following guidelines:



DANGER: Indicates an imminently hazardous situation that, if not avoided, will result in death or serious injury. This signal word is to be limited to the most extreme situations typically for machine components which, for functional purposes, cannot be guarded.



WARNING: Indicates a potentially hazardous situation that, if not avoided, could result in death or serious injury, and includes hazards that are exposed when guards are removed. It may also be used to alert against unsafe practices.



CAUTION: Indicates a potentially hazardous situation that, if not avoided, may result in minor or moderate injury. It may also be used to alert against unsafe practices.

Important Safety Information

General Safety Guidelines

Safety of the operator is one of the main concerns in designing and developing a new piece of equipment. Designers and manufacturers build in as many safety features as possible. However, every year many accidents occur which could have been avoided by a few seconds of thought and a more careful approach to handling equipment. You, the operator, can avoid many accidents by observing the following precautions in this section. To avoid personal injury, study the following precautions and insist those working with you, or for you, follow them.

Replace any **DANGER, WARNING, CAUTION** or instruction safety decal that is not readable or is missing. Location of such decals are indicated in this manual. Do not attempt to operate this equipment under the influence of drugs or alcohol.

Review the safety instructions with all users annually.

This equipment is dangerous to children and persons unfamiliar with its operation. The operator should be a responsible adult familiar with farm machinery and trained in this equipment's operations. **Do not allow persons to operate or assemble this unit until they have read this manual and have developed a thorough understanding of the safety precautions and of how it works.**

To prevent injury of death, use a tractor equipped with a Roll Over Protection System (ROPS). Do not paint over, remove or deface any signs or warning decals on your equipment. Observe all safety signs and practice the instructions on them.

Never exceed the limits of a piece of machinery. If its ability to do a job, or to do so safely, is in question - **Don't try it!**



Safety Decal Care

- Keep safety signs clean and legible at all times.
- Replace safety signs that are missing or have become illegible.
- Replaced parts that displayed a safety sign should also display the current safety sign
- Safety signs are available from your Distributor or Dealer Parts Department or the factory.

Important Safety Information

How to Install Safety Signs

- Be sure that the installation area is clean and dry.
- Decide on the exact position before you remove the backing paper.
- Remove the smallest portion of the split backing paper.
- Align the decal over the specified area and carefully press the small portion with the exposed sticky backing in place.
- Slowly peel back the remaining paper and carefully smooth the remaining portion of the decal in place.
- Small air pockets can be pierced with a straight pin and smoothed out using the piece of decal backing paper.



Before Operation

- Carefully study and understand this manual.
- Do not wear loose-fitting clothing, which may catch in moving parts.
- Always wear protective clothing and substantial shoes.
- Assure that all tires are inflated evenly.
- Give the machine a visual inspection for any loose bolts, worn parts or cracked welds, and make necessary repairs. Follow the maintenance safety instructions included with this manual.
- Be sure that there are no tools lying on or in the equipment.
- Do not use the machine until you are sure that the area is clear, especially of children and animals.
- Don't hurry the learning process or take the machine for granted. Ease into it and become familiar with your new equipment.
- Practice operation of your equipment and its attachments. Completely familiarize yourself and other operators with its operation before using.
- Use a tractor equipped with a Roll Over Protection System (ROPS) and fasten your seat belt prior to starting engine.
- The manufacturer does not recommend usage of tractor with ROPS removed.
- Move tractor wheels to the widest recommended settings to increase stability.
- Securely attach to towing unit. Use a high strength, appropriately sized hitch pin with a mechanical retainer and attach safety chain.
- Do not allow anyone to stand between the tongue or hitch and the towing vehicle when backing up to the equipment.

Important Safety Information



During Operation

- Children should not be allowed on the product.
- Clear the area of small children and bystanders before moving the machine.
- If using a towing unit, securely attach machine by using a hardened 3/4" pin, a metal retainer, and safety chains if required. Shift towing unit to a lower gear before going down steep downgrades, thus using the engine as a retarding force. Keep towing vehicle in gear at all times. Slow down for corners and rough terrain.
- Make sure you are in compliance with all local and state regulations regarding transporting equipment on public roads and highways. Lights and slow moving signs must be clean and visible by overtaking or oncoming traffic when machine is transported.
- Beware of bystanders, **particularly children!** Always look around to make sure that it is safe to start the engine of the towing vehicle or move the machine. This is particularly important with higher noise levels and quiet cabs, as you may not hear people shouting.
- **NO PASSENGERS ALLOWED!** Do not carry passengers anywhere on, or in, the tractor or equipment, except as required for operation.
- Keep hands and clothing clear of moving parts.
- Do not clean, lubricate or adjust your equipment while it is moving.
- When halting operation, even periodically, set the tractor or towing vehicle brakes, disengage the PTO, shut off the engine and **remove the ignition key.**
- Be especially observant of the operating area and terrain. Watch for holes, rocks or hidden hazards. Always inspect the area prior to operation.
- **DO NOT** operate near the edge of drop-offs or banks.
- **DO NOT** operate on steep slopes as overturns may result.
- Operate up and down (not across) intermediate slopes. Avoid sudden starts and stops.



Warning: Never backup with the machine on the ground! This will cause damage to the machine. Always lift the machine high enough to clear the ground before backing up.

Important Safety Information



Highway and Transport Operations

- Adopt safe driving practices.
- Keep the brake pedals latched together at all times. **Never use independent braking with machine in tow as loss of control and/or upset of machine can result.**
- Always drive at a safe speed relative to local conditions and ensure that your speed is low enough for an emergency stop to be safe and secure. Keep speed at a minimum.
- Reduce speed prior to turns to avoid the risk of overturning.
- Avoid sudden uphill turns on steep slopes.
- Always keep the tractor or towing vehicle in gear to provide engine braking when going downhill. Do not coast.
- Do not drink and drive!
- Comply with state and local laws governing highway safety and movement of farm machinery on public roads.
- Use approved accessory lighting flags and necessary warning devices to protect operators of other vehicles on the highway during daylight and nighttime transport. Various safety lights and devices are available from your dealer.
- The use of flashing amber lights is acceptable in most localities. However, some localities prohibit their use. Local laws should be checked for all highway and marking requirements.
- When driving the tractor and equipment on the road or highway under 40 kph (20 mph) at night or during the day, use the amber warning lights and a slow moving vehicle (SMV) identification emblem.
- Plan your route to avoid heavy traffic.
- Be a safe and courteous driver. Always yield to oncoming traffic in all situations, including narrow bridges, intersections, etc.
- Be observant of bridge loading ratings. Do not cross bridges rated at lower than the gross weight at which you are operating.
- Watch for obstructions overhead and to the side while transporting.
- Always operate in a position to provide maximum visibility at all times. Make allowances for increased length and weight of the equipment when making turns, stopping the machine, etc.
- Pick the most level route when transporting across fields. Avoid the edges of ditches or gullies and steep hillsides.
- Be extra careful when working in inclines.

Important Safety Information



Highway and Transport Operations

- Maneuver the tractor or towing vehicle at safe speeds.
- Avoid overhead wires or other obstacles. Contact with overhead lines could cause serious injury or death.
- Avoid loose fill, rocks and holes, they can be dangerous for equipment operation or movement.
- Allow for machine length when making turns,
- Operate the towing vehicle from the operator's seat only.
- Never stand alongside of machine with engine running or attempt to start engine and/or operate machine while standing alongside of machine.
- Never leave running equipment attachments unattended.
- As a precaution, always recheck the hardware on equipment following every 100 hours of operation. Correct all problems. Follow the maintenance safety procedures.

General Information

Machine Identification:

- Each machine has a nameplate with the most important identification details. The nameplate is located on the machine in such a place that it can be easily found and read.

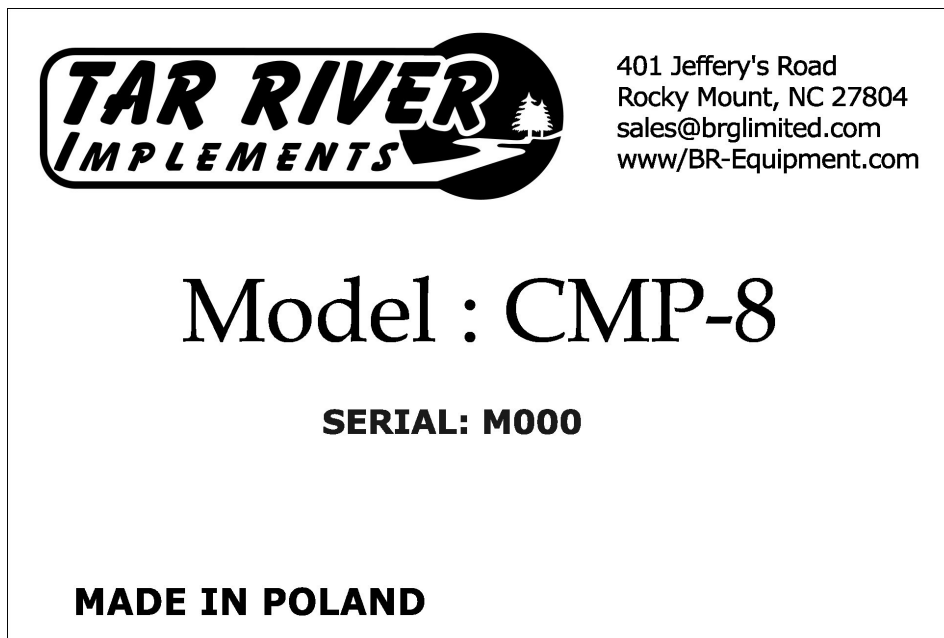







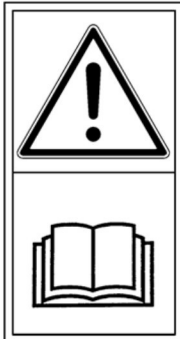
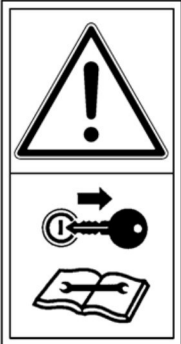

The manufacturer's nameplate shows:

- Full name of manufacturer,
- Roller serial number,
- Machine model designation

General Information

Safety signs on the machine and their meaning:

 <p>Read the manual before operating the machine.</p>	 <p>Switch off the engine and remove the ignition key before any servicing or maintenance procedures.</p>	 <p>Avoid exposure to liquid flowing under pressure. Read the manual and learn about the maintenance works.</p>
 <p>Do not approach or touch the shaft.</p>	 <p>Danger of injury by ejected objects. Keep a safe distance from the running machine.</p>	
	 <p>Wear a protective suit</p>	 <p>Wear protective gloves</p>
	 <p>Wear ear protectors</p>	 <p>Wear safety goggles</p>

Intended use of the machine

The grass roller is a machine for levelling crops on natural terrain. The machine should be operated, serviced and repaired by persons familiar with its specific characteristics and acquainted with the rules of conduct in terms of occupational safety. Accident prevention regulations and all basic health and safety rules, as well as the highway code must always be observed. Unauthorised changes in design of the machine without permission of the manufacturer will waive the manufacturer’s liability arising due to any resulting damage or injury.

Operating Instructions



Warning: When attaching the machine, *Never* allow anyone to stand between the machine and the tractor. Serious injury or death can occur. Make sure the tractor and machine cannot move while connecting them. Switch off the tractor engine before operating the machine.

Attaching the Machine

The machine must be connected and disconnected carefully while observing safety instructions. Follow the instructions below.

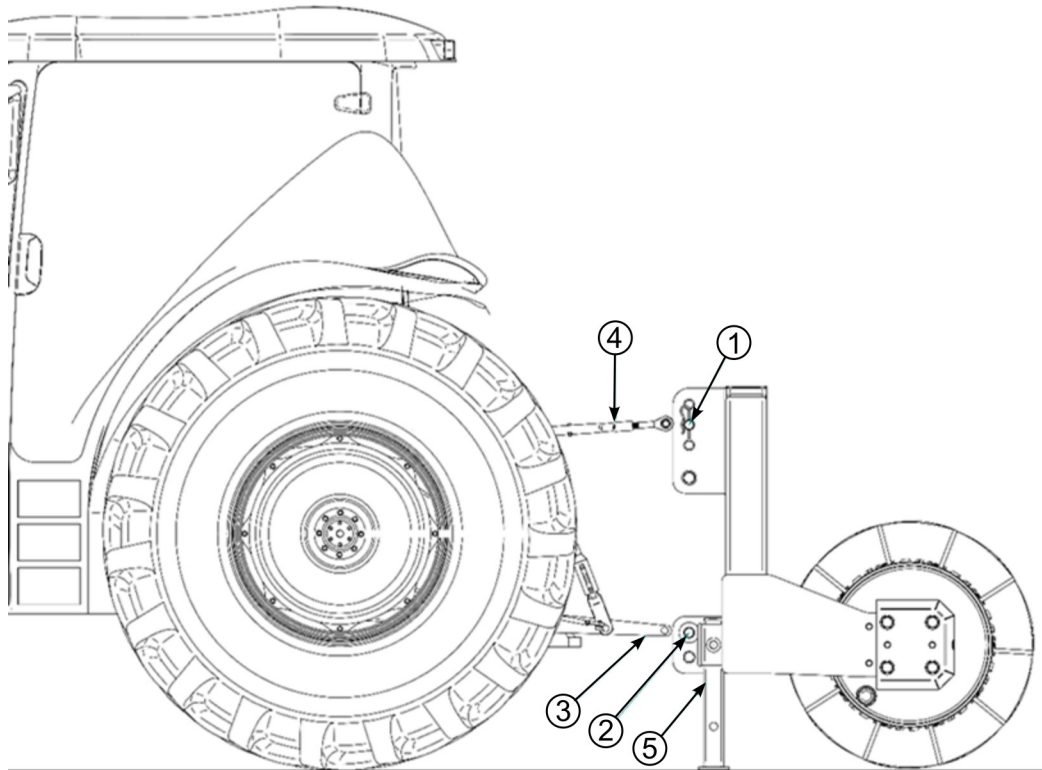

1. Remove the linkage pins (items 1 and 2).
2. In reverse gear, back the tractor towards the machine until it is possible to couple the lower rods of the tractor (item 3) to the machine using the pin (item 2).
3. Fasten the lower rods (item 3) with the pins (item 2) and secure the pins with a cotter pin.
4. Fasten the upper rod (item 4) to the machine with a pin (item 1) and secure the pin with a cotter pin.
5. Adjust the upper rod (item 4) so that the machine is horizontal to the ground.
6. Lift the machine and retract the support feet (item 5).

NOTE: When disconnecting the machine, follow the above instructions in reverse order.

Transport

1. When transporting the machine suspended it is recommended not to exceed a speed of 20 km/h. Due to the weight of the roller higher transport speeds may cause damage to the machine and the tractor.

Operating Instructions

Filling the working shaft with water

Fill the shaft with water to increase its weight. The filler/drain caps are located on the side guards of the shaft, on both sides (item 1).

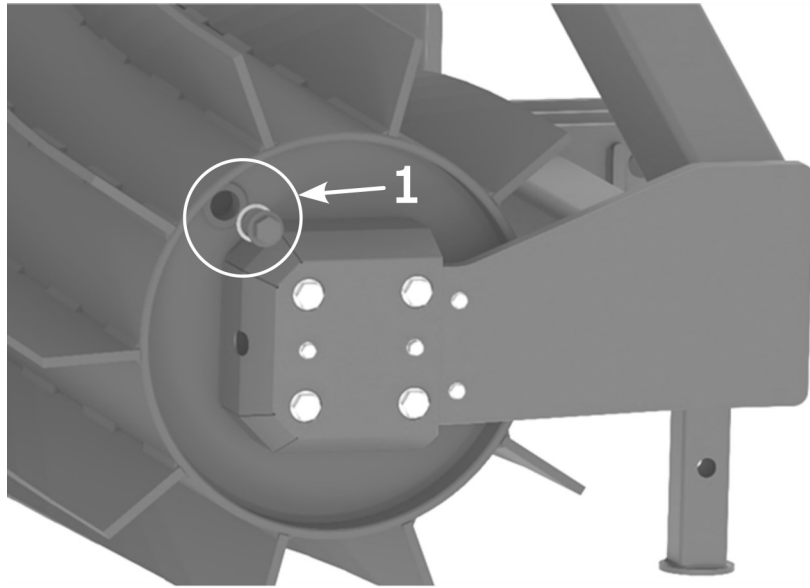

When filling the shaft, unscrew the cap on one side, the hole should be in the highest possible position. The caps on both sides are on the opposite side, relative to the shaft axis. When draining the shaft, both caps must be unscrewed to vent.

Each time check the condition of the sealing washer and replace if necessary.

Estimated shaft capacity	
Type	Quantity [L]
CMP-6	195
CMP-8	265
CMP-10	330



Warning: Remember to drain the shaft before the temperature drops and the water starts to freeze. Otherwise, the shaft may be damaged.

Maintenance

The operator of the vehicle to which the machine has been attached may carry out all actions related to its operation provided they have proper authorisation to operate this vehicle.



Warning: After disconnecting the machine from the vehicle, it should be stored under shelter on a flat and hard surface, supported on its foot.

Maintenance/Lubrication

Maintenance

The operator of the vehicle to which the machine has been attached may carry out all actions related to its operation provided they have proper authorisation to operate this vehicle.



Warning: After disconnecting the machine from the vehicle, it should be stored under shelter on a flat and hard surface, supported on its foot.

The machine operator must always check the technical condition of the machine before connecting the machine to the tractor. To do so, follow the procedure:

- Read and follow the instructions contained in this manual;
- Learn and understand the operation of the machine;
- Perform visual inspection of all elements of the machine, looking for any mechanical damage;
- Lubricate the machine as per the recommendations;
- Check the technical condition of the pins and the cotter pins in the hitch system;
- Check condition of the bolted joints;

Warning: Use only the original spare parts provided by the manufacturer, to guarantee safe and reliable operation of the machine. Using non-original parts or repairing damaged parts will void the warranty.



If all the above-listed steps have been performed, and the technical condition of the machine does not raise any doubts, it can be connected to the tractor.

Maintenance after work

Each time after finishing work, clean the machine, use pressure washer to wash it and position it on a flat and hard ground. Carry out an inspection of connections between the parts and units.

Replace damaged and worn out parts with new ones. Check all the bolted joints and tighten according to “Torque Spec” chart. Always check the condition of the hardware before operating machine.

Maintenance/Lubrication

Lubrication

To ensure proper operation, the machine must be carefully and properly lubricated. All lubrication points are marked below.



Warning: All maintenance and servicing works are to be performed with the vehicle engine switched off and the vehicle and machine secured.

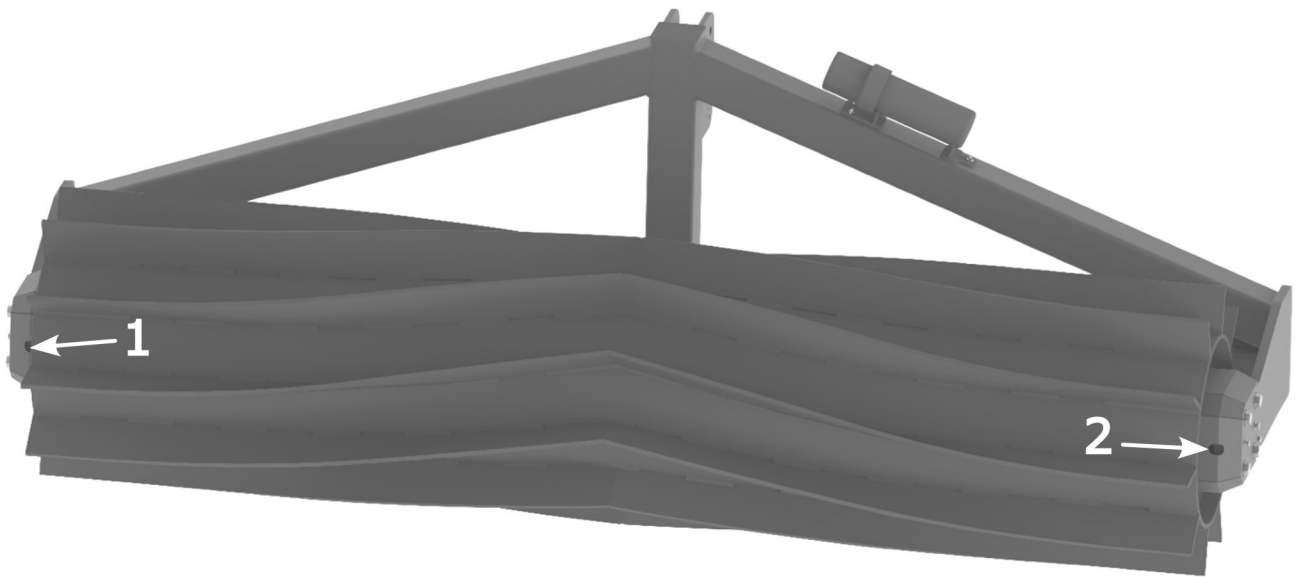

LUBRICATION POINTS				
Item	Description	Lubricant	Periodicity	
1, 2	Working shaft bearings	LT43	After the first 20 hours of operation	
			After every 100 hours of operation	

Out-of-season maintenance

Includes all the tasks listed in section 7.1 Maintenance after work. In addition, the machine should be stored under shelter, on a flat and hard surface and supported on its foot. Make sure the paint coat is intact. If there are any defects in the coat, clean the spot and apply new protective coating.

Possible problems and solutions

Problem symptoms	Problem cause	Possible solution
Working shaft does not rotate	Material entangled between shaft and bearing	Remove tangled material
	Shaft bearings are seized	Replace bearings
The crop is not entirely compacted	The machine weight is too low	Fill the working shaft with water (see section 6.3)

Maintenance/Lubrication

Disassembly, decommissioning and environment protection



Warning: Protect your hands (body) against injuries, and the harmful effects of lubricants and oils. Use protective gloves and tools which are in good mechanical condition.

Machine elements which can move or rotate during disassembly must be properly secured.

Worn or damaged parts removed during repair (decommissioning) should be stored in a separate location, with a limited access for persons and animals. Worn out metal parts must be delivered to the scrap metal collection points. Worn out plastics must be delivered to the chemical waste collection (disposal) points.



Warning: Abandoned parts or machine components and spilled oil may pose a risk of accident, cause an environmental pollution and violate applicable laws.

Torque Specifications

Torque Specifications for Common Bolt Sizes															
Inches		Bolt Head Identification						Metric		Bolt Head Identification					
										5.8		8.8		10.9	
Bolt size (inches)	Thread pitch	Grade 2		Grade 5		Grade 8		Class 5.8		Class 8.8		Class 10.9			
		N.m	ft-lb	N.m	ft-lb	N.m	ft-lb	N.m	ft-lb	N.m	ft-lb	N.m	ft-lb		
1/4"	20	7	5	11	8	16	12	M5	0.08	4	3	6	4	9	7
1/4"	28	8	6	13	10	19	14	M6	1	6	4	10	7	15	11
5/16"	18	15	11	24	17	33	25	M8	1.25	16	12	25	18	36	27
5/16"	24	17	13	26	19	37	27	M8	1	17	13	26	19	38	28
3/8"	16	27	20	42	31	59	44	M10	1.5	31	23	48	35	71	52
3/8"	24	31	23	47	35	67	49	M10	1.25	33	24	51	38	75	55
7/16"	14	43	32	67	49	95	70	M10	1	35	26	53	39	78	58
7/16"	20	48	36	75	55	106	78	M12	1.75	54	40	84	62	123	91
1/2"	13	66	48	102	75	144	106	M12	1.5	56	41	87	64	128	94
1/2"	20	75	55	115	85	163	120	M12	1.25	59	44	90	66	133	98
9/16"	12	95	70	147	109	208	154	M14	2	84	62	133	98	195	144
9/16"	18	106	79	164	121	232	171	M14	1.5	94	69	142	105	209	154
5/8"	11	132	97	203	150	287	212	M16	2	131	97	206	152	302	223
5/8"	18	149	110	230	170	325	240	M16	1.5	141	104	218	161	320	236
3/4"	10	233	172	361	266	509	376	M18	2.5	181	133	295	218	421	310
3/4"	16	261	192	403	297	569	420	M18	2	196	145	311	229	443	327
7/8"	9	226	167	582	430	822	606	M18	1.5	203	150	327	241	465	343
7/8"	14	249	184	642	473	906	668	M20	2.5	256	189	415	306	592	437
1"	8	339	250	873	644	1232	909	M20	1.5	288	212	454	335	646	476
1"	12	371	273	955	704	1348	995	M22	2.5	344	254	567	418	807	595
1-1/8"	7	480	354	1077	794	1746	1288	M22	1.5	381	281	613	452	873	644
1-1/8"	12	539	397	1208	891	1958	1445	M24	3	444	327	714	526	1017	750
1-1/4"	7	677	500	1519	1120	2463	1817	M24	2	488	360	769	567	1095	808
1-1/4"	12	750	553	1682	1241	2728	2012	M27	3	656	484	1050	774	1496	1103
1-3/8"	6	888	655	1992	1469	3230	2382	M27	2	719	530	1119	825	1594	1176
1-3/8"	12	1011	746	2268	1673	3677	2712	M30	3.5	906	668	1420	1047	2033	1499
1-1/2"	6	1179	869	2643	1949	4286	3161	M30	2	1000	738	1600	1180	2250	1659
1-1/2"	12	1326	978	2974	2194	4823	3557	M36	4	1534	1131	2482	1830	3535	2607

Notes:

This chart is an approximate estimate of torque values.

Always tighten hardware to these values unless a different torque value or tightening procedure is listed for a specific application.

Fasteners must always be replaced with the same grade as specified in the manual.

Always use the proper tool for tightening hardware: SAE for SAE hardware and Metric for Metric hardware.

Page left blank intentionally



Roller Crimper

CMP-6, CMP-8

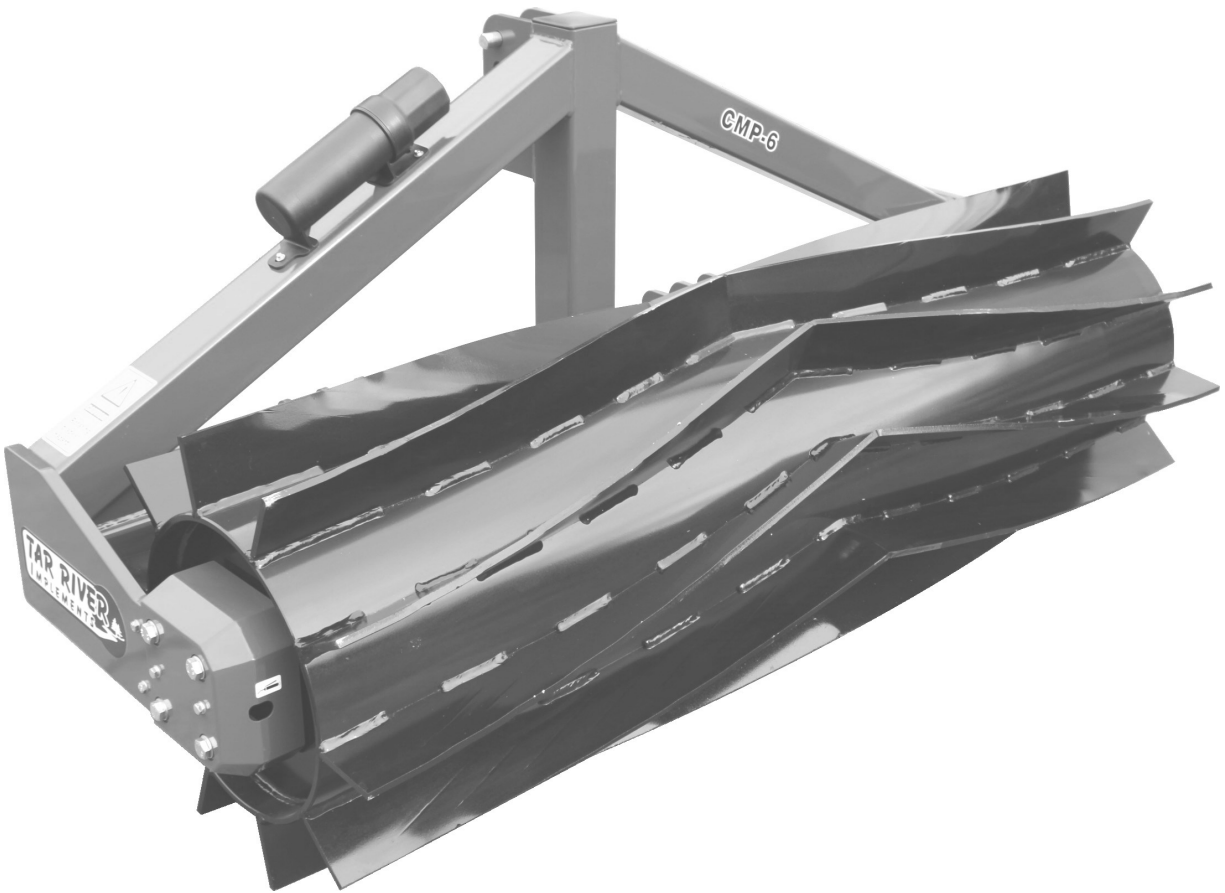

Parts Manual

Rel. 02/25

Header

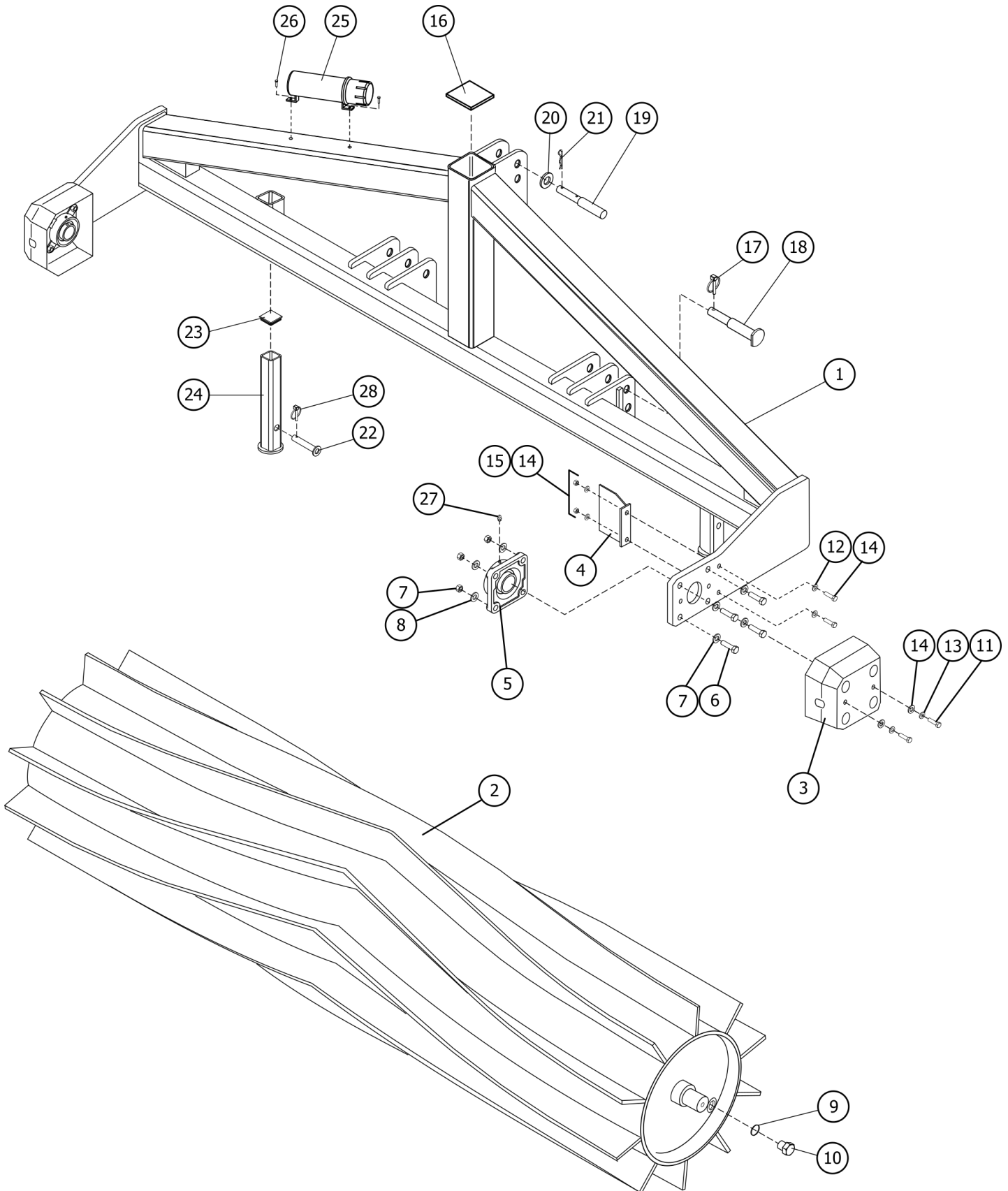

Header

Item	Part #	Description	Qty.
1	CMP10001	Roller crimper frame, CMP-06	1
	CMP10002	Roller crimper frame, CMP-08	1
	CMP10003	Roller crimper frame, CMP-10	1
2	CMP10004	Roller crimper rotor, CMP-06	1
	CMP10005	Roller crimper rotor, CMP-08	1
	CMP10006	Roller crimper rotor, CMP-10	1
3	CMP10007	Roller bearing cover, external	2
4	CMP10008	Roller bearing cover, internal	2
5	BUCF210	Bearing UCF210	2
6	BM162060PT	Bolt M16-2.0x60 C8.8 partial thread zinc	8
7	FW16	Washer flat M16 zinc	16
8	LN1620	Nut self locking M16-2.0 zinc	8
9	CMP10009	Copper washer 30x38x2	2
10	CMP10010	Drain plug M30x1.5 H-31	2
11	BM0812520FT	Bolt M8-1.25x20 C8.8 full thread zinc	4
12	BM0812535FT	Bolt M8-1.25x35 C8.8 full thread zinc	4
13	LW08	Washer lock M8 zinc	4
14	FW08	Flat washer M08 zinc	12
15	LN08125	Nut self locking M08-1.25 zinc	4
16	CMP10011	Square plug 100x100	1
17	CMP10012	Lower rod pin, cat 1 & 2 roller	2
18	LYNPN10	Lynch pin - M10	2
19	CMP10013	Upper hitch pin	1
20	FW20	Washer flat M20 zinc	1
21	TW18189	Double locking pin	1
22	CMP10014	Ø19 pin with cotter pin	2
23	CMP10015	Square plug 50x50	2
24	CMP10016	Roller crimper stand	2
25	MH10000	Manual holder - large	1
26	CMP10017	Screw self drilling M4.8x25 Din 7504E	3
27	GN061S	Grease Nipple- M6 x 1.0 Straight	2
28	LYNPN08	Lynch pin - M08	1

Warranty

LIMITED WARRANTY

Belco Resources Equipment warrants to the original purchaser of any new piece of machinery from Belco Resources Equipment, purchased from an authorized Belco Resources Equipment dealer, that the equipment be free from defects in material and workmanship for a period of one (1) year for non-commercial, state, and municipalities' use, ninety (90) days for commercial use from date of retail sale. Warranty for rental purposes is thirty (30) days. The obligation of Belco Resources Equipment to the purchaser under this warranty is limited to the repair or replacement of defective parts.

Replacement or repair parts installed in the equipment covered by this limited warranty are warranted for ninety (90) days from the date of purchase of such part or to the expiration of the applicable new equipment warranty period, whichever occurs later. Warranted parts shall be provided at no cost to the user at an authorized Belco Resources Equipment dealer during regular working hours. Belco Resources Equipment reserves the right to inspect any equipment or parts, which are claimed to have been defective in material or workmanship.

This limited warranty does not apply to and excludes wear items such as shear pins, tires, tubes knives, blades or other wear items. Oil or grease is not covered by this warranty.

All obligations of Belco Resources Equipment under this limited warranty shall be terminated if:

- Proper service is not performed on the machine.

- The machine is modified or altered in any way.

- The machine is being used or has been used for purposes other than those for which the machine was intended.

DISCLAIMER OF IMPLIED WARRANTIES & CONSEQUENTIAL DAMAGES

Belco Resources Equipment obligation under this limited warranty, to the extent allowed by law, is in lieu of all warranties, implied or expressed, including implied warranties of merchantability and fitness for a particular purpose and any liability for incidental and consequential damages with respect to the sale or use of the items warranted. Such incidental and consequential damages shall include but not be limited to: transportation charges other than normal freight charges; cost of installation other than cost approved by Belco Resources Equipment; duty; taxes; charges for normal service or adjustment; loss of crops or any other loss of income; rental of substitute equipment, expenses due to loss, damage, detention or delay in the delivery.

REGISTRATION

The online Warranty Registration must be completed in order to qualify for coverage on this Limited Warranty. Visit br-equipment.com, click on "Warranty Registration" and completely fill out the form to register the new piece of equipment.

Page left blank intentionally



401 Jeffreys Road
Rocky Mount, NC 27804
www.tarrivermfg.com

Tel: 252-822-7140
Fax: 252-787-5855
Sales@tarrivermfg.com